

NOTES:

- FOR A C.C.W. ROTATION, AS VIEWED FROM LEAD END, ENERGIZE PER EXCITATION SEQUENCE BELOW.
- MOTOR SUPPLIED AS TWO SEPARATE COMPONENTS, ARMATURE ASSEMBLY AND FIELD ASSEMBLY
- MINIMUM MOUNTING SURFACE FROM 251.71[9.910] TO 259.60[10.220] BOTH SIDES.
- DIMENSIONS IN BRACKETS [] ARE ENGLISH UNITS FOR REFERENCE ONLY.
- NO ANGULAR RELATIONSHIP BETWEEN MOUNTING HOLES ON EITHER SIDE OF ROTOR.
- RoHS (DIRECTIVE 2002/95/EC AND AMMENDMENTS) COMPLIANCE REQUIRED.

REVISION				
REV	ECN NO.	DESCRIPTION	DATE	APPROVED

MOTOR LEADS :
 #16 AWG, TEFLON INSULATED, U.L. 1199
 3 LEADS, 400 MM [15.75"] MIN
 1- BLUE 1-BROWN 1-VIOLET

THERMISTOR LEADS :
 #26 AWG, TEFLON INSULATED
 2 LEADS, 400 MM [15.75"] MIN
 1-BLUE 1-RED

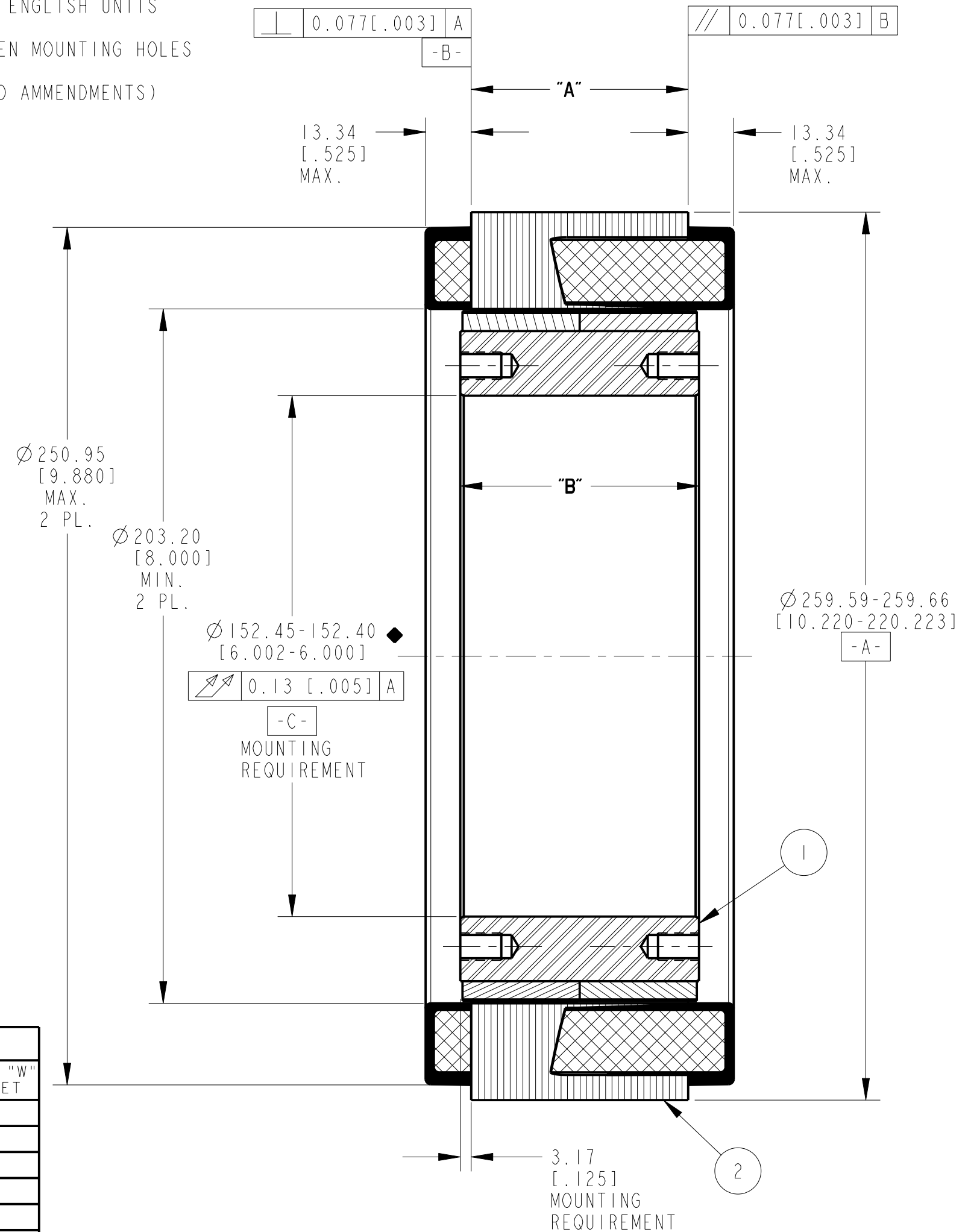

MARK MODEL NO, SERIAL NO & FSCM NO. PER ITEM #3

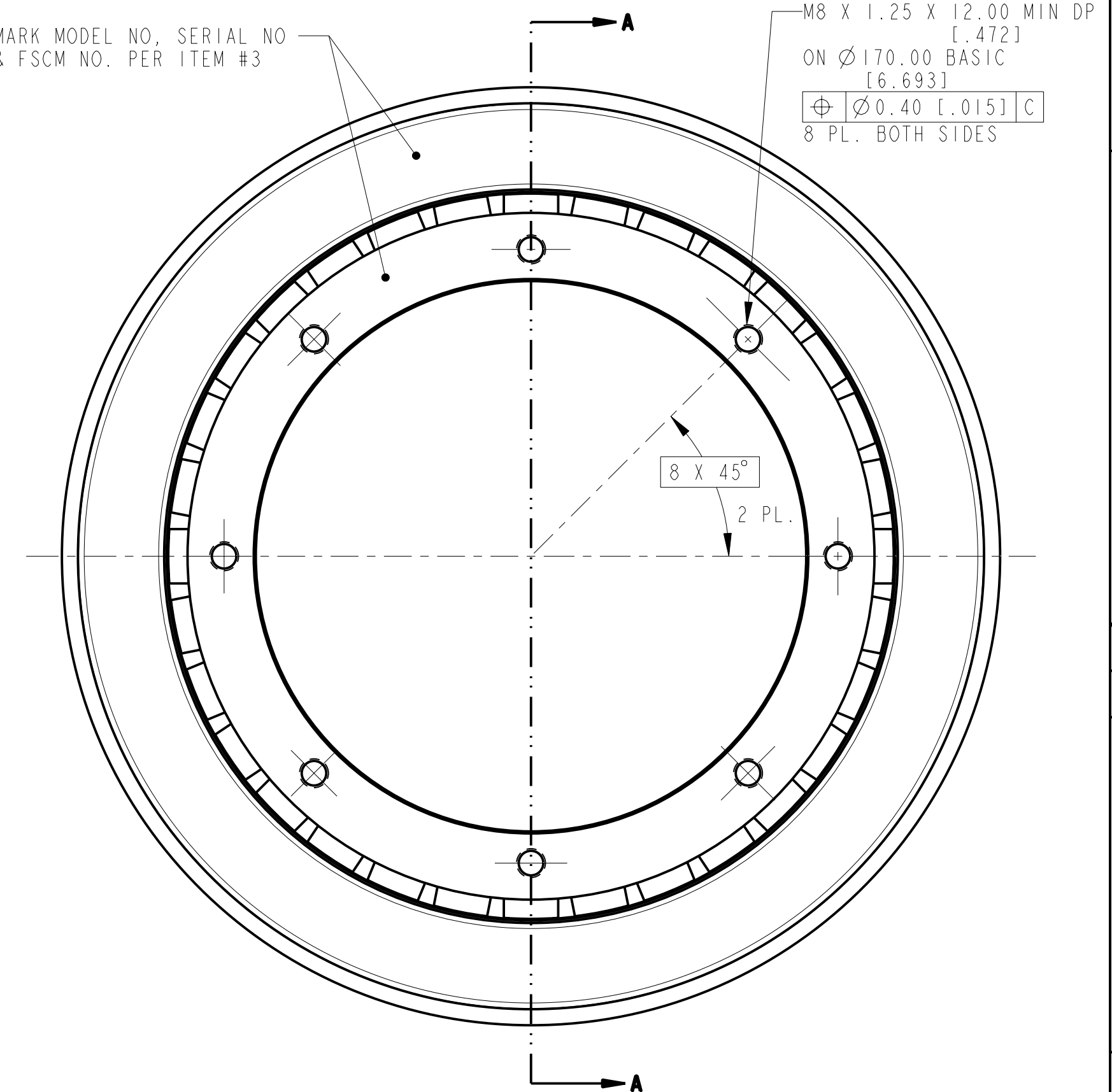

POWER CONNECTION			
STEP	PHASE "U" BLUE	PHASE "V" BROWN	PHASE "W" VIOLET
1	+	-	
2	+		-
3		+	-
4	-	+	
5	-		+
6		-	+

EXCITATION SEQUENCE TABLE

SECTION A-A

THIS DOCUMENT IS ONLY FOR USE BY THE INTENDED RECIPIENT AND CONTAINS KOLLMORGEN CONFIDENTIAL INFORMATION

Pro/E Instance Name	KBM19_OUTLINE_946460
Pro/E Drawing Name	946460
Pro/E Model Type	ASSEM

Pro/Engineer Drawing

TABLE 1					
MODEL NUMBER	ARMATURE ASSY H.V. INSULATION	ARMATURE ASSY STD. INSULATION	FIELD ASSEMBLY	DIM "A"	DIM "B"
KBM-79X01	946461/01X	946462/01X	946463/01	31.75 [1.250]	38.10 [1.500]
KBM-79X02	946461/02X	946462/02X	946463/02	63.50 [2.500]	69.85 [2.750]
KBM-79X03	946461/03X	946462/03X	946463/03	127.00 [5.000]	133.35 [5.250]

3	AR	IM-2709	MARKING PROCEDURE
2	I	SEE TABLE	ARMATURE ASSEMBLY
1	I	SEE TABLE	FIELD ASSEMBLY
ITEM	QTY	IDENTIFYING NO.	DESCRIPTION
LIST OF PARTS			
UNLESS OTHERWISE SPECIFIED: REMOVE ALL SHARP BURRS AND BREAK ALL SHARP EDGES X DECIMAL PLACES ±.4 [.015] XX DECIMAL PLACES ±.13 [.005] ANGULAR DIMENSIONS ±1°		KOLLMORGEN Inland Motor INLAND MOTOR 501 FIRST STREET RADFORD, VIRGINIA 24141	
DO NOT SCALE DRAWING, USE DIMENSIONS ONLY ALL DIMENSIONS ARE IN MILLIMETERS DIMENSIONS IN BRACKETS [] ARE IN INCHES AND ARE FOR REFERENCE ONLY.		OUTLINE KBM-79XXX-X00	
SIGNIFICANT PRODUCT CHARACTERISTIC CRITICAL PRODUCT CHARACTERISTIC		FSCM 11384	SIZE C
INTERPRET GEOMETRIC SYMBOLS PER ANSI Y14.5M-1982		DWG. NO. 946460	REV -
THIRD ANGLE PROJECTION		SCALE: 1.000	SHEET 1 OF 1

DWG. NO. 946460